

**INITIAL STUDY/NEGATIVE DECLARATION**

[Pursuant to Public Resources Code Section 21080(c) and California Code of Regulations, Title 14, Sections 15070-15071]

**LEAD AGENCY:** San Joaquin County Community Development Department

**PROJECT APPLICANT:** Insurance Auto Auctions, Inc.

**PROJECT TITLE/FILE NUMBER(S):** PA-1900197 (SA)

**PROJECT DESCRIPTION:** A Site Approval application for an auction sales facility to be developed on a 139.8-acre parcel in the General Industrial Zone (I-G). The project includes the construction of a 9,750 square foot office building and a 5,088 square foot warehouse building. The operation will take place 8:00 a.m. to 5:00 p.m. Monday through Friday with fifty (50) employees. Deliveries of vehicles will take place 5:00 p.m. to 8:00 a.m. seven (7) days per week. The parcel will be served by public sewer by the City of Stockton, public water by the California Water Service, and public storm drainage by San Joaquin County. Access to the parcel will be off of Cherokee Lane and Newton Road. This parcel is not under a Williamson Act contract. (Use Type: Auction Sales - Indoor & Outdoor).

The project is located on the northwest corner of Newton Road and Cherokee Road, east of Stockton.

**ASSESSORS PARCEL NO(S):** 132-070-10

**ACRES:** 139.8 acres

**GENERAL PLAN:** I/G (General Industrial)

**ZONING:** I-G (General Industrial)

**POTENTIAL POPULATION, NUMBER OF DWELLING UNITS, OR SQUARE FOOTAGE OF USE(S):**  
The construction of a 9,750 square foot office building and a 5,088 square foot warehouse building.

**SURROUNDING LAND USES:**

**NORTH:** Industrial, Commercial  
**SOUTH:** Industrial and Residential  
**EAST:** Industrial and Residential  
**WEST:** Industrial, Commercial, Agricultural, and Public Facilities

**REFERENCES AND SOURCES FOR DETERMINING ENVIRONMENTAL IMPACTS:**

Original source materials and maps on file in the Community Development Department including: all County and City general plans and community plans; assessor parcel books; various local and FEMA flood zone maps; service district maps; maps of geologic instability; maps and reports on endangered species such as the Natural Diversity Data Base; noise contour maps; specific roadway plans; maps and/or records of archeological/historic resources; soil reports and maps; etc.

Many of these original source materials have been collected from other public agencies or from previously prepared EIR's and other technical studies. Additional standard sources which should be specifically cited below include on-site visits by staff (August 4, 2020) and staff knowledge or experience. Copies of these reports can be found by contacting the Community Development Department.

**TRIBAL CULTURAL RESOURCES:**

Have California Native American tribes traditionally and culturally affiliated with the project area requested consultation pursuant to Public Resources Code section 21080.3.1? If so, is there a plan for consultation that includes, for example, the determination of significance of impacts to tribal cultural resources, procedures regarding confidentiality, etc.?

No.



**GENERAL CONSIDERATIONS:**

1. Does it appear that any environmental feature of the project will generate significant public concern or controversy?

Yes  No

Nature of concern(s):

2. Will the project require approval or permits by agencies other than the County?

Yes  No

Agency name(s):

3. Is the project within the Sphere of Influence, or within two miles, of any city?

Yes  No

City: Stockton





**ENVIRONMENTAL FACTORS POTENTIALLY AFFECTED:**

The environmental factors checked below would be potentially affected by this project, involving at least one impact that is a "**Potentially Significant Impact**" as indicated by the checklist on the following pages.

- |  |   |   |
|--|---|---|
| <input type="checkbox"/> Aesthetics                  | <input type="checkbox"/> Agriculture and Forestry Resources | <input type="checkbox"/> Air Quality                        |
| <input type="checkbox"/> Biological Resources        | <input type="checkbox"/> Cultural Resources                 | <input type="checkbox"/> Energy                             |
| <input type="checkbox"/> Geology / Soils             | <input type="checkbox"/> Greenhouse Gas Emissions           | <input type="checkbox"/> Hazards & Hazardous Materials      |
| <input type="checkbox"/> Hydrology / Water Quality   | <input type="checkbox"/> Land Use / Planning                | <input type="checkbox"/> Mineral Resources                  |
| <input type="checkbox"/> Noise                       | <input type="checkbox"/> Population / Housing               | <input type="checkbox"/> Public Services                    |
| <input type="checkbox"/> Recreation                  | <input type="checkbox"/> Transportation                     | <input type="checkbox"/> Tribal Cultural Resources          |
| <input type="checkbox"/> Utilities / Service Systems | <input type="checkbox"/> Wildfire                           | <input type="checkbox"/> Mandatory Findings of Significance |

**DETERMINATION:** (To be completed by the Lead Agency) On the basis of this initial evaluation:

- I find that the proposed project **COULD NOT** have a significant effect on the environment, and a **NEGATIVE DECLARATION** will be prepared.
- I find that although the proposed project could have a significant effect on the environment, there will not be a significant effect in this case because revisions in the project have been made by or agreed to by the project proponent. A **MITIGATED NEGATIVE DECLARATION** will be prepared.
- I find that the proposed project **MAY** have a significant effect on the environment, and an **ENVIRONMENTAL IMPACT REPORT** is required.
- I find that the proposed project **MAY** have a "potentially significant impact" or "potentially significant unless mitigated" impact on the environment, but at least one effect 1) has been adequately analyzed in an earlier document pursuant to applicable legal standards, and 2) has been addressed by mitigation measures based on the earlier analysis as described on attached sheets. An **ENVIRONMENTAL IMPACT REPORT** is required, but it must analyze only the effects that remain to be addressed.
- I find that although the proposed project could have a significant effect on the environment, because all potentially significant effects (a) have been analyzed adequately in an earlier **EIR** or **NEGATIVE DECLARATION** pursuant to applicable standards, and (b) have been avoided or mitigated pursuant to that earlier **EIR** or **NEGATIVE DECLARATION**, including revisions or mitigation measures that are imposed upon the proposed project, nothing further is required.

Signature Teddie [Signature]

Date 9 Oct 2020

## EVALUATION OF ENVIRONMENTAL IMPACTS:

- 1) A brief explanation is required for all answers except "No Impact" answers that are adequately supported by the information sources a lead agency cites in the parentheses following each question. A "No Impact" answer is adequately supported if the referenced information sources show that the impact simply does not apply to projects like the one involved (e.g., the project falls outside a fault rupture zone). A "No Impact" answer should be explained where it is based on project-specific factors as well as general standards (e.g., the project will not expose sensitive receptors to pollutants, based on a project-specific screening analysis).
- 2) All answers must take account of the whole action involved, including off-site as well as on-site, cumulative as well as project-level, indirect as well as direct, and construction as well as operational impacts.
- 3) Once the lead agency has determined that a particular physical impact may occur, then the checklist answers must indicate whether the impact is potentially significant, less than significant with mitigation, or less than significant. "Potentially Significant Impact" is appropriate if there is substantial evidence that an effect may be significant. If there are one or more "Potentially Significant Impact" entries when the determination is made, an EIR is required.
- 4) "Negative Declaration: Less Than Significant With Mitigation Incorporated" applies where the incorporation of mitigation measures has reduced an effect from "Potentially Significant Impact" to a "Less Than Significant Impact." The lead agency must describe the mitigation measures, and briefly explain how they reduce the effect to a less than significant level (mitigation measures from "Earlier Analyses," as described in (5) below, may be cross-referenced).
- 5) Earlier analyses may be used where, pursuant to the tiering, program EIR, or other CEQA process, an effect has been adequately analyzed in an earlier EIR or negative declaration. Section 15063(c)(3)(D). In this case, a brief discussion should identify the following:
  - a) Earlier Analysis Used. Identify and state where they are available for review.
  - b) Impacts Adequately Addressed. Identify which effects from the above checklist were within the scope of and adequately analyzed in an earlier document pursuant to applicable legal standards, and state whether such effects were addressed by mitigation measures based on the earlier analysis.
  - c) Mitigation Measures. For effects that are "Less than Significant with Mitigation Measures Incorporated," describe the mitigation measures which were incorporated or refined from the earlier document and the extent to which they address site-specific conditions for the project.
- 6) Lead agencies are encouraged to incorporate into the checklist references to information sources for potential impacts (e.g., general plans, zoning ordinances). Reference to a previously prepared or outside document should, where appropriate, include a reference to the page or pages where the statement is substantiated.
- 7) Supporting Information Sources: A source list should be attached, and other sources used or individuals contacted should be cited in the discussion.
- 8) This is only a suggested form, and lead agencies are free to use different formats; however, lead agencies should normally address the questions from this checklist that are relevant to a project's environmental effects in whatever format is selected.
- 9) The explanation of each issue should identify:
  - a) the significance criteria or threshold, if any, used to evaluate each question; and
  - b) the mitigation measure identified, if any, to reduce the impact to less than significance.

**ISSUES:**

**I. AESTHETICS.**

Except as provided in Public Resources Code Section 21099, would the project:

	Potentially Significant Impact	Less Than Significant with Mitigation Incorporated	Less Than Significant Impact	No Impact	Analyzed In The Prior EIR
a) Have a substantial adverse effect on a scenic vista?	<input type="checkbox"/>	<input type="checkbox"/>	<input type="checkbox"/>	<input checked="" type="checkbox"/>	<input type="checkbox"/>
b) Substantially damage scenic resources, including, but not limited to, trees, rock outcroppings, and historic buildings within a state scenic highway?	<input type="checkbox"/>	<input type="checkbox"/>	<input type="checkbox"/>	<input checked="" type="checkbox"/>	<input type="checkbox"/>
c) In non-urbanized areas, substantially degrade the existing visual character or quality of public views of the site and its surroundings? (Public views are those that are experienced from publically accessible vantage point). If the project is in an urbanized area, would the project conflict with applicable zoning and other regulations governing scenic quality?	<input type="checkbox"/>	<input type="checkbox"/>	<input type="checkbox"/>	<input checked="" type="checkbox"/>	<input type="checkbox"/>
d) Create a new source of substantial light or glare which would adversely affect day or nighttime views in the area?	<input type="checkbox"/>	<input type="checkbox"/>	<input checked="" type="checkbox"/>	<input type="checkbox"/>	<input type="checkbox"/>

**Impact Discussion:**

- a-c) The proposed project is a Site Approval application for an auction sales facility. The proposed structures and all improvements will be required to meet all building setbacks and Development Title requirements. This project will be conditioned with requirements for landscaping along roadways bordering the project parcel. The project site is not located along a designated scenic route pursuant to 2035 General Plan Figure 12-2, and the surrounding area is a mixture of industrial and commercial uses. As a result, the proposed project is not anticipated to have an impact on aesthetics.
- d) The proposed project will be subject to the regulations outlined in Development Title Section 9-1015.5(g) that pertain to lighting for commercial development. As a result, the effects of light and glare for daytime or nighttime views in the area are expected to be less than significant.



Potentially Significant Impact	Less Than Significant with Mitigation Incorporated	Less Than Significant Impact	No Impact	Analyzed In The Prior EIR
--------------------------------------	---	------------------------------------	--------------	---------------------------------

**II. AGRICULTURE AND FORESTRY RESOURCES.**

In determining whether impacts to agricultural resources are significant environmental effects, lead agencies may refer to the California Agricultural Land Evaluation and Site Assessment Model (1997) prepared by the California Dept. of Conservation as an optional model to use in assessing impacts on agriculture and farmland. In determining whether impacts to forest resources, including timberland, are significant environmental effects, lead agencies may refer to information compiled by the California Department of Forestry and Fire Protection regarding the state's inventory of forest land, including the Forest and Range Assessment Project and the Forest Legacy Assessment project; and forest carbon measurement methodology provided in Forest Protocols adopted by the California Air Resources Board. -- Would the project:

- |  |                          |                                     |                          |                          |                          |
|--|--------------------------|-------------------------------------|--------------------------|--------------------------|--------------------------|
| a) Convert Prime Farmland, Unique Farmland, or Farmland of Statewide Importance (Farmland), as shown on the maps prepared pursuant to the Farmland Mapping and Monitoring Program of the California Resources Agency, to nonagricultural use?  | <input type="checkbox"/> | <input checked="" type="checkbox"/> | <input type="checkbox"/> | <input type="checkbox"/> | <input type="checkbox"/> |
| b) Conflict with existing zoning for agricultural use, or a Williamson Act contract?   | <input type="checkbox"/> | <input checked="" type="checkbox"/> | <input type="checkbox"/> | <input type="checkbox"/> | <input type="checkbox"/> |
| c) Conflict with existing zoning for, or cause rezoning of, forest land (as defined in Public Resources Code section 12220(g)), timberland (as defined by Public Resources Code section 4526), or timberland zoned Timberland Production (as defined by Government Code section 51104(g))? | <input type="checkbox"/> | <input checked="" type="checkbox"/> | <input type="checkbox"/> | <input type="checkbox"/> | <input type="checkbox"/> |
| d) Result in the loss of forest land or conversion of forest land to non-forest use?   | <input type="checkbox"/> | <input checked="" type="checkbox"/> | <input type="checkbox"/> | <input type="checkbox"/> | <input type="checkbox"/> |
| e) Involve other changes in the existing environment which, due to their location or nature, could result in conversion of Farmland, to non-agricultural use or conversion of forest land to non-forest use?   | <input type="checkbox"/> | <input checked="" type="checkbox"/> | <input type="checkbox"/> | <input type="checkbox"/> | <input type="checkbox"/> |

**Impact Discussion:**

a-e) The project parcel's General Plan and zoning designations were changed from an agricultural designation to an industrial designation as a result of General Plan Map Amendment and Zone Reclassification applications in 2014. The San Joaquin County Development Title requires Agricultural Mitigation when a parcel goes from an agricultural to non-agricultural use. Pursuant to Development Title Section 9-1080.3(c), agricultural mitigation shall be satisfied by granting a farmland conservation easement or other farmland conservation mechanism set forth in San Joaquin County Development Title Section 9-1080.3(d) to or for the benefit of a Qualifying Entity. The number of acres of agricultural mitigation land shall be at least equal to the number of acres that will be changed to a nonagricultural use (1:1 ratio). As a result, compliance with the Agricultural Mitigation ordinance will be included in the project's Conditions of Approval, and required prior to issuance of a grading or building permit. Therefore, the impact to agriculture and forestry resources will be reduced to less than significant.

Potentially Significant Impact	Less Than Significant with Mitigation Incorporated	Less Than Significant Impact	No Impact	Analyzed In The Prior EIR
--------------------------------------	---	------------------------------------	--------------	---------------------------------

**III. AIR QUALITY.**

Where available, the significance criteria established by the applicable air quality management or air pollution control district may be relied upon to make the following determinations. Would the project:

a) Conflict with or obstruct implementation of the applicable air quality plan?	<input type="checkbox"/>	<input type="checkbox"/>	<input checked="" type="checkbox"/>	<input type="checkbox"/>	<input type="checkbox"/>
b) Result in a cumulatively considerable net increase of any criteria pollutant for which the project region is non-attainment under an applicable federal or state ambient air quality standard?	<input type="checkbox"/>	<input type="checkbox"/>	<input checked="" type="checkbox"/>	<input type="checkbox"/>	<input type="checkbox"/>
c) Expose sensitive receptors to substantial pollutant concentrations?	<input type="checkbox"/>	<input type="checkbox"/>	<input checked="" type="checkbox"/>	<input type="checkbox"/>	<input type="checkbox"/>
d) Result in substantial emissions (such as those leading to odors) adversely affecting a substantial number of people?	<input type="checkbox"/>	<input type="checkbox"/>	<input checked="" type="checkbox"/>	<input type="checkbox"/>	<input type="checkbox"/>

**Impact Discussion:**

a-d) The proposed project is A Site Approval application for an auction sales facility to be developed on a 139.8-acre parcel in the General Industrial Zone (I-G). The project includes the construction of a 9,750 square foot office building and a 5,088 square foot warehouse building. The project site is located in the San Joaquin Valley Air Basin, which is regulated by the San Joaquin Valley Air Pollution Control District (SJVAPCD). SJVAPCD is the lead air quality regulatory agency for San Joaquin. This project was referred to the SJVAPCD for review on November 22, 2019. In a letter dated December 18, 2019, SJVAPCD responded that the project as proposed will not exceed the District's significant thresholds of pollutant. The applicant will be required to meet existing requirements for emissions and dust control as established by SJVAPCD. As a result, any impacts to air quality are expected to be less than significant.

	Potentially Significant Impact	Less Than Significant with Mitigation Incorporated	Less Than Significant Impact	No Impact	Analyzed In The Prior EIR
--	--------------------------------	--	------------------------------	-----------	---------------------------

**IV. BIOLOGICAL RESOURCES.**

Would the project:

a) Have a substantial adverse effect, either directly or through habitat modifications, on any species identified as a candidate, sensitive, or special status species in local or regional plans, policies, or regulations, or by the California Department of Fish and Game or U.S. Fish and Wildlife Service?	<input type="checkbox"/>	<input checked="" type="checkbox"/>	<input type="checkbox"/>	<input type="checkbox"/>	<input type="checkbox"/>
b) Have a substantial adverse effect on any riparian habitat or other sensitive natural community identified in local or regional plans, policies, regulations or by the California Department of Fish and Game or US Fish and Wildlife Service?	<input type="checkbox"/>	<input checked="" type="checkbox"/>	<input type="checkbox"/>	<input type="checkbox"/>	<input type="checkbox"/>
c) Have a substantial adverse effect on state or federally protected wetlands (including, but not limited to, marsh, vernal pool, coastal, etc.) through direct removal, filling, hydrological interruption, or other means?	<input type="checkbox"/>	<input type="checkbox"/>	<input type="checkbox"/>	<input checked="" type="checkbox"/>	<input type="checkbox"/>
d) Interfere substantially with the movement of any native resident or migratory fish or wildlife species or with established native resident or migratory wildlife corridors, or impede the use of native wildlife nursery sites?	<input type="checkbox"/>	<input type="checkbox"/>	<input type="checkbox"/>	<input checked="" type="checkbox"/>	<input type="checkbox"/>
e) Conflict with any local policies or ordinances protecting biological resources, such as a tree preservation policy or ordinance?	<input type="checkbox"/>	<input type="checkbox"/>	<input type="checkbox"/>	<input checked="" type="checkbox"/>	<input type="checkbox"/>
f) Conflict with the provisions of an adopted Habitat Conservation Plan, Natural Community Conservation Plan, or other approved local, regional, or state habitat conservation plan?	<input type="checkbox"/>	<input type="checkbox"/>	<input type="checkbox"/>	<input checked="" type="checkbox"/>	<input type="checkbox"/>

**Impact Discussion:**

- a) The California Department of Fish and Wildlife Natural Diversity Database lists Swainson's hawk (*Buteo swainsoni*) and Giant Garter Snake (*Thamnophis giga*) as rare, endangered, or threatened species or habitat located on or near the site for the proposed project. Referrals have been sent to the San Joaquin Council of Governments (SJCOG), the agency responsible for verifying the correct implementation of the *San Joaquin County Multi-Species Habitat Conservation and Open Space Plan* (SJMSCP), which provides compensation for the conversion of Open Space to non-Open Space uses which affect the plant, fish and wildlife species covered by the Plan. Pursuant to the Final EIR/EIS for SJMSCP, dated November 15, 2000, and certified by SJCOG on December 7, 2000, implementation of the SJMSCP is expected to reduce impacts to biological resources resulting from the proposed project to a level of less-than-significant. Additionally, the project site is not within a riparian area depicted in the General Plan, is approximately fifty (50) feet from the Stockton Diverting Canal waterway, and is not within a wetland area.

SJCOG responded in a letter dated November 25, 2019, that the project site is subject to the SJMSCP. The applicant has confirmed that they will participate in SJMSCP. With the applicant's participation, the proposed project is consistent with the SJMSCP and any impacts to biological resources resulting from the proposed project will be reduced to a level of less-than-significant.



- b-c) The southern property line of the project site abuts the Stockton Diverting Canal. Pursuant to DT 9-1510.5, a 100 foot natural open space will be required from the mean high water mark will be required as a condition of approval. Therefore, the impacts of the proposed project will have on riparian habitat or wetlands will be reduced to less than significant.
- d) The project's impact on resident or migratory wildlife corridors will be reduced to less than significant because the project applicant will participate in the San Joaquin Multi-Species Habitat Conservation and Open Space Plan (SJMSCP). Implementation of the SJMSCP is expected to reduce impacts to biological resources resulting from the proposed project to a level of less-than-significant.
- e) The projects impact on protected biological resources will be reduced to less than significant because the project applicant will participate in the San Joaquin Multi-Species Habitat Conservation and Open Space Plan (SJMSCP). Implementation of the SJMSCP is expected to reduce impacts to biological resources resulting from the proposed project to a level of less-than-significant.

The project site is not expected to interfere with local policies protecting biological resources because the applicant will be required to comply with the County's policy, under Development Title Section 9-1505.3, regarding protecting Native Oak Trees, Heritage Oak Trees, or Historical Trees. There are currently 47 Oak Trees on the property, the project will be conditioned to protect and/or provide for replacement of all trees. In this way, any impact to protected biological resources will be reduced to less than significant.

- f) The project will not conflict with the provisions of an adopted Habitat Conservation Plan, natural Community Conservation Plan, or other approved local, regional, or state habitat conservation plan, because the project applicant will participate in the San Joaquin Multi-Species Habitat Conservation and Open Space Plan (SJMSCP). Implementation of the SJMSCP is expected to reduce impacts to biological resources resulting from the proposed project to a level of less-than-significant.

Potentially Significant Impact	Less Than Significant with Mitigation Incorporated	Less Than Significant Impact	No Impact	Analyzed In The Prior EIR
--------------------------------------	---	------------------------------------	--------------	---------------------------------

**V. CULTURAL RESOURCES.**

Would the project:

a) Cause a substantial adverse change in the significance of a historical resource pursuant to § 15064.5?	<input type="checkbox"/>	<input type="checkbox"/>	<input type="checkbox"/>	<input checked="" type="checkbox"/>	<input type="checkbox"/>
b) Cause a substantial adverse change in the significance of an archaeological resource pursuant to § 15064.5?	<input type="checkbox"/>	<input type="checkbox"/>	<input type="checkbox"/>	<input checked="" type="checkbox"/>	<input type="checkbox"/>
c) Disturb any human remains, including those interred outside of dedicated cemeteries?	<input type="checkbox"/>	<input type="checkbox"/>	<input checked="" type="checkbox"/>	<input type="checkbox"/>	<input type="checkbox"/>

**Impact Discussion:**

- a-b) The proposed project will have no impact on Cultural Resources as there are no resources on the project site that are listed or are eligible for listing on a local register, the California Register of Historic Places, or National Register of Historic Places.
- c) The North Valley Yokuts Tribe and the United Auburn Indian Community were sent a referral for the project on November 22, 2019 and a response was not received. In the event human remains are encountered during any portion of the project, California state law requires that there shall be no further excavation or disturbance of the site or any nearby area reasonably suspected to overlie adjacent remains until the coroner of the county has determined manner and cause of death, and the recommendations concerning the treatment and disposition of the human remains have been made to the person responsible for the excavation (California Health and Safety Code - Section 7050.5). This will be added to the final Conditional of Approval.



	Potentially Significant Impact	Less Than Significant with Mitigation Incorporated	Less Than Significant Impact	No Impact	Analyzed In The Prior EIR
--	--------------------------------	--	------------------------------	-----------	---------------------------

**VI. ENERGY.**

Would the project:

- |  |                          |                          |                                     |                          |                          |
|--|--------------------------|--------------------------|-------------------------------------|--------------------------|--------------------------|
| a) Result in a potentially significant environmental impact due to wasteful, inefficient, or unnecessary consumption of energy, or wasteful use of energy resources, during project construction or operation? | <input type="checkbox"/> | <input type="checkbox"/> | <input checked="" type="checkbox"/> | <input type="checkbox"/> | <input type="checkbox"/> |
| b) Conflict with or obstruct a state or local plan for renewable energy or energy efficiency?  | <input type="checkbox"/> | <input type="checkbox"/> | <input checked="" type="checkbox"/> | <input type="checkbox"/> | <input type="checkbox"/> |

**Impact Discussion:**

- a-b) The California Energy Code (also titled The Energy Efficiency Standards for Residential and Non-residential Buildings) was created by the California Building Standards Commission in response to a legislative mandate to reduce California's energy consumption. The code's purpose is to advance the state's energy policy, develop renewable energy sources and prepare for energy emergencies. These standards are updated periodically by the California Energy Commission. The code includes energy conservation standards applicable to most buildings throughout California. These requirements will be applicable to the proposed project ensuring that any impact to the environment due to wasteful, inefficient, or unnecessary consumption of energy will be less than significant and preventing any conflict with state or local plans for energy efficiency and renewable energy.

	Potentially Significant Impact	Less Than Significant with Mitigation Incorporated	Less Than Significant Impact	No Impact	Analyzed In The Prior EIR
--	--------------------------------	--	------------------------------	-----------	---------------------------

**VII. GEOLOGY AND SOILS.**

Would the project:

a) Directly or indirectly cause potential substantial adverse effects, including the risk of loss, injury, or death involving:	<input type="checkbox"/>	<input type="checkbox"/>	<input checked="" type="checkbox"/>	<input type="checkbox"/>	<input type="checkbox"/>
i) Rupture of a known earthquake fault, as delineated on the most recent Alquist-Priolo Earthquake Fault Zoning Map issued by the State Geologist for the area or based on other substantial evidence of a known fault? Refer to Division of Mines and Geology Special Publication 42.	<input type="checkbox"/>	<input type="checkbox"/>	<input checked="" type="checkbox"/>	<input type="checkbox"/>	<input type="checkbox"/>
ii) Strong seismic ground shaking?	<input type="checkbox"/>	<input type="checkbox"/>	<input checked="" type="checkbox"/>	<input type="checkbox"/>	<input type="checkbox"/>
iii) Seismic-related ground failure, including liquefaction?	<input type="checkbox"/>	<input type="checkbox"/>	<input checked="" type="checkbox"/>	<input type="checkbox"/>	<input type="checkbox"/>
iv) Landslides?	<input type="checkbox"/>	<input type="checkbox"/>	<input checked="" type="checkbox"/>	<input type="checkbox"/>	<input type="checkbox"/>
b) Result in substantial soil erosion or the loss of topsoil?	<input type="checkbox"/>	<input type="checkbox"/>	<input checked="" type="checkbox"/>	<input type="checkbox"/>	<input type="checkbox"/>
c) Be located on a geologic unit or soil that is unstable, or that would become unstable as a result of the project, and potentially result in on- or off-site landslide, lateral spreading, subsidence, liquefaction or collapse?	<input type="checkbox"/>	<input type="checkbox"/>	<input checked="" type="checkbox"/>	<input type="checkbox"/>	<input type="checkbox"/>
d) Be located on expansive soil and create direct or indirect risks to life or property?	<input type="checkbox"/>	<input type="checkbox"/>	<input checked="" type="checkbox"/>	<input type="checkbox"/>	<input type="checkbox"/>
e) Have soils incapable of adequately supporting the use of septic tanks or alternative waste water disposal systems where sewers are not available for the disposal of waste water?	<input type="checkbox"/>	<input type="checkbox"/>	<input checked="" type="checkbox"/>	<input type="checkbox"/>	<input type="checkbox"/>
f) Directly or indirectly destroy a unique paleontological resource or site or unique geologic feature?	<input type="checkbox"/>	<input type="checkbox"/>	<input checked="" type="checkbox"/>	<input type="checkbox"/>	<input type="checkbox"/>

**Impact Discussion:**

- The geology of San Joaquin County is composed of high organic alluvium, which is susceptible to earthquake movement. The project will have to comply with the California Building Code (CBC) which includes provisions for soils reports for grading and foundations as well as design criteria for seismic loading and other geologic hazards based on fault and seismic hazard mapping. All recommendations from a soils report must be incorporated into the construction plans.
- The project will not result in substantial soil erosion or the loss of topsoil because the project will require a grading permit. Therefore, the grading will be done under permit and inspection by the San Joaquin County Community Development Department's Building Division. As a result, impacts to soil erosion or loss of topsoil will be less than significant.

- c-d) The project site is relatively flat terrain where landslides have not historically been an issue. A soils report will be required for grading and foundations and all recommendations from a soils report must be incorporated into the construction plans. Therefore, any risks resulting from being located on an unstable unit will be reduced to less than significant.
- e) The project will be served by City of Stockton Sewer District and California Water Service. There are no wells with in the project site.



	Potentially Significant Impact	Less Than Significant with Mitigation Incorporated	Less Than Significant Impact	No Impact	Analyzed In The Prior EIR
--	--------------------------------	--	------------------------------	-----------	---------------------------

**VIII. GREENHOUSE GAS EMISSIONS.**

Would the project:

- |  |                          |                          |                                     |                          |                          |
|--|--------------------------|--------------------------|-------------------------------------|--------------------------|--------------------------|
| a) Generate greenhouse gas emissions, either directly or indirectly, that may have a significant impact on the environment?      | <input type="checkbox"/> | <input type="checkbox"/> | <input checked="" type="checkbox"/> | <input type="checkbox"/> | <input type="checkbox"/> |
| b) Conflict with an applicable plan, policy or regulation adopted for the purpose of reducing the emissions of greenhouse gases? | <input type="checkbox"/> | <input type="checkbox"/> | <input checked="" type="checkbox"/> | <input type="checkbox"/> | <input type="checkbox"/> |

**Impact Discussion:**

- a-b) Emissions of GHGs contributing to global climate change are attributable in large part to human activities associated with the industrial/manufacturing, utility, transportation, residential, and agricultural sectors. Therefore, the cumulative global emissions of GHGs contributing to global climate change can be attributed to every nation, region, and city, and virtually every individual on earth. An individual project's GHG emissions are at a micro-scale level relative to global emissions and effects to global climate change; however, an individual project could result in a cumulatively considerable incremental contribution to a significant cumulative macro-scale impact. As such, impacts related to emissions of GHG are inherently considered cumulative impacts.

Implementation of the proposed project would cumulatively contribute to increases of GHG emissions. Estimated GHG emissions attributable to future development would be primarily associated with increases of carbon dioxide (CO<sub>2</sub>) and, to a lesser extent, other GHG pollutants, such as methane (CH<sub>4</sub>) and nitrous oxide (N<sub>2</sub>O) associated with area sources, mobile sources or vehicles, utilities (electricity and natural gas), water usage, wastewater generation, and the generation of solid waste. The primary source of GHG emissions for the project would be mobile source emissions. The common unit of measurement for GHG is expressed in terms of annual metric tons of CO<sub>2</sub> equivalents (MTCO<sub>2</sub>e/yr).

As noted previously, the proposed project will be subject to the rules and regulations of the SJVAPCD. The SJVAPCD has adopted the *Guidance for Valley Land-use Agencies in Addressing GHG Emission Impacts for New Projects under CEQA* and the *District Policy – Addressing GHG Emission Impacts for Stationary Source Projects Under CEQA When Serving as the Lead Agency*. (I) The guidance and policy rely on the use of performance-based standards, otherwise known as Best Performance Standards (BPS) to assess significance of project specific greenhouse gas emissions on global climate change during the environmental review process, as required by CEQA. To be determined to have a less-than-significant individual and cumulative impact with regard to GHG emissions, projects must include BPS sufficient to reduce GHG emissions by 29 percent when compared to Business As Usual (BAU) GHG emissions. Per the SJVAPCD, BAU is defined as projected emissions for the 2002-2004 baseline period. Projects which do not achieve a 29 percent reduction from BAU levels with BPS alone are required to quantify additional project-specific reductions demonstrating a combined reduction of 29 percent. Potential mitigation measures may include, but not limited to: on-site renewable energy (e.g. solar photovoltaic systems), electric vehicle charging stations, the use of alternative-fueled vehicles, exceeding Title 24 energy efficiency standards, the installation of energy-efficient lighting and control systems, the installation of energy-efficient mechanical systems, the installation of drought-tolerant landscaping, efficient irrigation systems, and the use of low-flow plumbing fixtures.

It should be noted that neither the SJVAPCD nor the County provide project-level thresholds for construction-related GHG emissions. Construction GHG emissions are a one-time release and are, therefore, not typically expected to generate a significant contribution to global climate change. As such, the analysis herein is limited to discussion of long-term operational GHG emissions.

(I) San Joaquin Valley Air Pollution Control District. *Guidance for Valley Land-use Agencies in Addressing GHG Emission Impacts for New Projects under CEQA*. December 17, 2009. San Joaquin Valley Air Pollution Control District. *District Policy Addressing GHG Emission Impacts for Stationary Source Projects Under CEQA When Serving as the Lead Agency*.

	Potentially Significant Impact	Less Than Significant with Mitigation Incorporated	Less Than Significant Impact	No Impact	Analyzed In The Prior EIR
--	--------------------------------	--	------------------------------	-----------	---------------------------

**IX. HAZARDS AND HAZARDOUS MATERIALS.**

Would the project:

a) Create a significant hazard to the public or the environment through the routine transport, use, or disposal of hazardous materials?	<input type="checkbox"/>	<input type="checkbox"/>	<input checked="" type="checkbox"/>	<input type="checkbox"/>	<input type="checkbox"/>
b) Create a significant hazard to the public or the environment through reasonably foreseeable upset and accident conditions involving the release of hazardous materials into the environment?	<input type="checkbox"/>	<input type="checkbox"/>	<input checked="" type="checkbox"/>	<input type="checkbox"/>	<input type="checkbox"/>
c) Emit hazardous emissions or handle hazardous or acutely hazardous materials, substances, or waste within one-quarter mile of an existing or proposed school?	<input type="checkbox"/>	<input type="checkbox"/>	<input checked="" type="checkbox"/>	<input type="checkbox"/>	<input type="checkbox"/>
d) Be located on a site which is included on a list of hazardous materials sites compiled pursuant to Government Code Section 65962.5 and, as a result, would it create a significant hazard to the public or the environment?	<input type="checkbox"/>	<input type="checkbox"/>	<input checked="" type="checkbox"/>	<input type="checkbox"/>	<input type="checkbox"/>
e) For a project located within an airport land use plan or, where such a plan has not been adopted, within two miles of a public airport or public use airport, would the project result in a safety hazard or excessive noise for people residing or working in the project area?	<input type="checkbox"/>	<input type="checkbox"/>	<input type="checkbox"/>	<input checked="" type="checkbox"/>	<input type="checkbox"/>
f) Impair implementation of or physically interfere with an adopted emergency response plan or emergency evacuation plan?	<input type="checkbox"/>	<input type="checkbox"/>	<input checked="" type="checkbox"/>	<input type="checkbox"/>	<input type="checkbox"/>
g) Expose people or structures, either directly or indirectly, to a significant risk of loss, injury or death involving wildland fires, including where wildlands are adjacent to urbanized areas or where residences are intermixed with wildlands?	<input type="checkbox"/>	<input type="checkbox"/>	<input checked="" type="checkbox"/>	<input type="checkbox"/>	<input type="checkbox"/>

**Impact Discussion:**

a-g) The proposed application would not result in, create or induce hazards and associated risks to the public. Construction activities for the project typically involve the use of toxic or hazardous materials such as paint, fuels, and solvents. Construction activities would be subject to federal, state, and local laws and requirements designed to minimize and avoid potential health and safety risks associated with hazardous materials. No significant impacts are anticipated related to the transport, use, or storage of hazardous materials during construction activities are anticipated.

The project site does not fall within the Airport Influence Area the comprehensive Airport Land Use Plan boundaries for the Stockton Metropolitan Airport. The project site is located approximately 5 miles north of the nearest runway. As a result, there will be no impact to airport flight paths.



	Potentially Significant Impact	Less Than Significant with Mitigation Incorporated	Less Than Significant Impact	No Impact	Analyzed In The Prior EIR
<b><u>X. HYDROLOGY AND WATER QUALITY.</u></b>					
Would the project:					
a) Violate any water quality standards or waste discharge requirements or otherwise substantially degrade surface or ground water quality?	<input type="checkbox"/>	<input type="checkbox"/>	<input checked="" type="checkbox"/>	<input type="checkbox"/>	<input type="checkbox"/>
b) Substantially decrease groundwater supplies or interfere substantially with groundwater recharge such that the project may impede sustainable groundwater management of the basin?	<input type="checkbox"/>	<input type="checkbox"/>	<input checked="" type="checkbox"/>	<input type="checkbox"/>	<input type="checkbox"/>
c) Substantially alter the existing drainage pattern of the site or area, including through the alteration of the course of a stream or river or through the addition of impervious surfaces, in a manner which would:	<input type="checkbox"/>	<input type="checkbox"/>	<input checked="" type="checkbox"/>	<input type="checkbox"/>	<input type="checkbox"/>
i) result in substantial erosion or siltation on- or off-site;	<input type="checkbox"/>	<input type="checkbox"/>	<input checked="" type="checkbox"/>	<input type="checkbox"/>	<input type="checkbox"/>
ii) substantially increase the rate or amount of surface runoff in a manner which would result in flooding on- or off-site;	<input type="checkbox"/>	<input type="checkbox"/>	<input checked="" type="checkbox"/>	<input type="checkbox"/>	<input type="checkbox"/>
iii) create or contribute runoff water which would exceed the capacity of existing or planned stormwater drainage systems or provide substantial additional sources of polluted runoff; or	<input type="checkbox"/>	<input type="checkbox"/>	<input checked="" type="checkbox"/>	<input type="checkbox"/>	<input type="checkbox"/>
iv) impede or redirect flood flows?	<input type="checkbox"/>	<input type="checkbox"/>	<input checked="" type="checkbox"/>	<input type="checkbox"/>	<input type="checkbox"/>
d) In flood hazard, tsunami, or seiche zones, risk release of pollutants due to project inundation?	<input type="checkbox"/>	<input type="checkbox"/>	<input checked="" type="checkbox"/>	<input type="checkbox"/>	<input type="checkbox"/>
e) Conflict with or obstruct implementation of a water quality control plan or sustainable groundwater management plan?	<input type="checkbox"/>	<input type="checkbox"/>	<input checked="" type="checkbox"/>	<input type="checkbox"/>	<input type="checkbox"/>

**Impact Discussion:**

d-e) The project site is located in the Flood Zone AH, 1 percent annual chance of flood designations. A referral has been sent to the Department of Public Works, Flood Control Division for comments. In a letter dated September 14, 2020, the Department of Public Works states the 100-Year Flood Elevation will be approximately 29 feet NAVD 1988. If approved, any new developments will have to comply with Development Title Section 9-1605 regarding flood hazards.

The project site is located approximately 50 feet north of the Stockton Diverting Canal. Uses to the north, south, east, and west are industrial, commercial, agricultural and residential. The proposed auction sales facility is an infill project in an urban area. A referral was sent to the Central Valley Regional Water Quality Control Board for review. As a Condition of Approval, the project will be subject to the Water Board's rules and regulations. As a result, the effects the project will have on waterways in the vicinity are expected to be less than significant.

	Potentially Significant Impact	Less Than Significant with Mitigation Incorporated	Less Than Significant Impact	No Impact	Analyzed In The Prior EIR
--	--------------------------------	--	------------------------------	-----------	---------------------------

**XI. LAND USE AND PLANNING.**

Would the project:

- |  |                          |                          |                                     |                                     |                          |
|--|--------------------------|--------------------------|-------------------------------------|-------------------------------------|--------------------------|
| a) Physically divide an established community?   | <input type="checkbox"/> | <input type="checkbox"/> | <input type="checkbox"/>            | <input checked="" type="checkbox"/> | <input type="checkbox"/> |
| b) Cause a significant environmental impact due to a conflict with any land use plan, policy, or regulation adopted for the purpose of avoiding or mitigating an environmental effect? | <input type="checkbox"/> | <input type="checkbox"/> | <input checked="" type="checkbox"/> | <input type="checkbox"/>            | <input type="checkbox"/> |

**Impact Discussion:**

- a) The construction and operation of the proposed project will not physically divide an established community. The project is an orderly extension of the commercial and industrial development that is established within the urban community of Stockton and the project is a commercial use adjacent to properties zoned for commercial use. Therefore, the project's impact on an established community would be less than significant.
- b) The proposed project is a Site Approval Application for an auction sales facility. The project proposes the construction of 9,750 square foot office building and a 5,088 square foot warehouse building. The project is not a growth-inducing action nor is it in conflict with any existing or planned uses. The project will not set a significant land use precedent in the area. There are no applicable Master Plans, Special Purpose Plans, or Specific Plans in the vicinity.

Potentially Significant Impact	Less Than Significant with Mitigation Incorporated	Less Than Significant Impact	No Impact	Analyzed In The Prior EIR
--------------------------------------	---	------------------------------------	--------------	---------------------------------

**XII. MINERAL RESOURCES.**

Would the project:

- |  |                          |                          |                          |                                     |                          |
|--|--------------------------|--------------------------|--------------------------|-------------------------------------|--------------------------|
| a) Result in the loss of availability of a known mineral resource that would be of value to the region and the residents of the state?                                 | <input type="checkbox"/> | <input type="checkbox"/> | <input type="checkbox"/> | <input checked="" type="checkbox"/> | <input type="checkbox"/> |
| b) Result in the loss of availability of a locally- important mineral resource recovery site delineated on a local general plan, specific plan or other land use plan? | <input type="checkbox"/> | <input type="checkbox"/> | <input type="checkbox"/> | <input checked="" type="checkbox"/> | <input type="checkbox"/> |

**Impact Discussion:**

- a, b) The proposed project will not result in the loss of availability of a known mineral resource of a resource recovery site because the site does not contain minerals of significance or known mineral resources. San Joaquin County applies a mineral resource zone (MRZ) designation to land that meets the significant mineral deposits definition by the State Division of Mines and Geology. Although the project site is in an area designated MRZ-1, there is currently no mining activity in the area, and the surrounding area is developed with residential, industrial, and commercial uses. Therefore, the proposed project applications will have less than a significant impact on the availability of mineral resources or mineral resource recovery sites within San Joaquin County.



Potentially Significant Impact	Less Than Significant with Mitigation Incorporated	Less Than Significant Impact	No Impact	Analyzed In The Prior EIR
--------------------------------------	---	------------------------------------	--------------	---------------------------------

**XIII. NOISE.**

Would the project result in:

- |   |                          |                          |                                     |                          |                          |
|---|--------------------------|--------------------------|-------------------------------------|--------------------------|--------------------------|
| a) Generation of a substantial temporary or permanent increase in ambient noise levels in the vicinity of the project in excess of standards established in the local general plan or noise ordinance, or applicable standards of other agencies?   | <input type="checkbox"/> | <input type="checkbox"/> | <input checked="" type="checkbox"/> | <input type="checkbox"/> | <input type="checkbox"/> |
| b) Generation of excessive groundborne vibration or groundborne noise levels?   | <input type="checkbox"/> | <input type="checkbox"/> | <input checked="" type="checkbox"/> | <input type="checkbox"/> | <input type="checkbox"/> |
| c) For a project within the vicinity of a private airstrip or an airport land use plan, or where such a plan has not been adopted, within two miles of a public airport or public use airport, would the project expose people residing or working in the project area to excessive noise levels? | <input type="checkbox"/> | <input type="checkbox"/> | <input checked="" type="checkbox"/> | <input type="checkbox"/> | <input type="checkbox"/> |

**Impact Discussion:**

- c. The nearest conforming single family residence is located approximately 380 feet south of the project site, on the south side of the Stockton Diverting Canal. Development Title Section 9-1025.9 lists the Residential use type as a noise sensitive land use. Development Title Section Table 9-1025.9 Part I states that the maximum sound level for transportation noise is 65dB. This applies to outdoor activity areas of the receiving use, or applies at the lot line if no activity area is known. The proposed project is subject to these Development Title standards. The primary noise source would be transportation noise from the auction sale facility with surrounding Industrial uses. All trucks will use East Cherokee Road and North Newton Road, and will not directly impact the residence. Therefore, noise impacts from the proposed project are expected to be less than significant.

Potentially Significant Impact	Less Than Significant with Mitigation Incorporated	Less Than Significant Impact	No Impact	Analyzed In The Prior EIR
--------------------------------------	---	------------------------------------	--------------	---------------------------------

**XIV. POPULATION AND HOUSING.**

Would the project:

- |   |                          |                          |                                     |                          |                          |
|---|--------------------------|--------------------------|-------------------------------------|--------------------------|--------------------------|
| a) Induce substantial unplanned population growth in an area, either directly (for example, by proposing new homes and businesses) or indirectly (for example, through extension of roads or other infrastructure)? | <input type="checkbox"/> | <input type="checkbox"/> | <input checked="" type="checkbox"/> | <input type="checkbox"/> | <input type="checkbox"/> |
| b) Displace substantial numbers of existing people or housing, necessitating the construction of replacement housing elsewhere?   | <input type="checkbox"/> | <input type="checkbox"/> | <input checked="" type="checkbox"/> | <input type="checkbox"/> | <input type="checkbox"/> |

**Impact Discussion:**

- a-b) The proposed project will not result in displacement of the population and affect the amount of proposed or existing housing in Stockton. Jobs and employment opportunities created from the project would most likely be absorbed by the employment needs of the existing residents of the area. Therefore, the projects impact on population and housing will be less than significant.

	Potentially Significant Impact	Less Than Significant with Mitigation Incorporated	Less Than Significant Impact	No Impact	Analyzed In The Prior EIR
--	--------------------------------	--	------------------------------	-----------	---------------------------

**XV. PUBLIC SERVICES.**

a) Would the project result in substantial adverse physical impacts associated with the provision of new or physically altered governmental facilities, need for new or physically altered governmental facilities, the construction of which could cause significant environmental impacts, in order to maintain acceptable service ratios, response times or other performance objectives for any of the public services:

Fire protection?	<input type="checkbox"/>	<input type="checkbox"/>	<input type="checkbox"/>	<input checked="" type="checkbox"/>	<input type="checkbox"/>
Police protection?	<input type="checkbox"/>	<input type="checkbox"/>	<input type="checkbox"/>	<input checked="" type="checkbox"/>	<input type="checkbox"/>
Schools?	<input type="checkbox"/>	<input type="checkbox"/>	<input type="checkbox"/>	<input checked="" type="checkbox"/>	<input type="checkbox"/>
Parks?	<input type="checkbox"/>	<input type="checkbox"/>	<input type="checkbox"/>	<input checked="" type="checkbox"/>	<input type="checkbox"/>
Other public facilities?	<input type="checkbox"/>	<input type="checkbox"/>	<input type="checkbox"/>	<input checked="" type="checkbox"/>	<input type="checkbox"/>

**Impact Discussion:**

a) The proposed project is A Site Approval application for an auction sales facility to be developed on a 139.8-acre parcel in the General Industrial Zone (I-G). The project includes the construction of a 9,750 square foot office building and a 5,088 square foot warehouse building. The project site is located in the Waterloo-Morada Fire District and the Stockton Unified School District. Both agencies were provided with the project proposal and invited to respond with any concerns or conditions. A letter dated November 26, 2019 was received from the San Joaquin County Fire Prevention stating the project will be subject to the following:

- (1) CFC 507 Fire Protection Water Supply - Fire flow and hydrants shall be provided for the proposed project by the use of: CFC Appendix B.
- (2) If Fire Protection Systems are required they shall be installed according to the CFC, Chapter 9 and the appropriate standards and guides adopted in Chapter 35 of the California Building Code and the California Electrical Code.
- (3) CFC, Section 503 Fire Apparatus Access Roads - Shall be provided as required by this section.
- (4) CFC, Section 906 Portable Fire Extinguishers – Provide portable fire extinguishers as required by this section.
- (5) CFC, Section 506 Key Box - A Knox® Box shall be installed according to the local fire department's instructions. Make application for the key box at the fire district having jurisdiction of this project. If there is an electronically controlled access gate at this site a Knox® key switch will also be required.
- (6) CFC, Section 5001.3.3.1 Properties of Hazardous Materials – A complete list of hazardous materials used and or stored at this site shall be provided.
- (7) A complete review, at building permit submittal, will require compliance with applicable codes and ordinances.
- (8) CFC, Section 105 Permits: Operational Permit(s) may be required prior to occupancy.

A response was not received from the Stockton Unified School District. The project site is served by the San Joaquin County Sheriff's Office. The office was provided with the project proposal and invited to respond with any concerns or conditions. A response was not received from that office. As proposed, the project is not anticipated to result in a need for a substantial change to public services.

	Potentially Significant Impact	Less Than Significant with Mitigation Incorporated	Less Than Significant Impact	No Impact	Analyzed In The Prior EIR
--	--------------------------------	--	------------------------------	-----------	---------------------------

**XVI. RECREATION.**

a) Would the project increase the use of existing neighborhood and regional parks or other recreational facilities such that substantial physical deterioration of the facility would occur or be accelerated?

<input type="checkbox"/>	<input type="checkbox"/>	<input type="checkbox"/>	<input checked="" type="checkbox"/>	<input type="checkbox"/>
--------------------------	--------------------------	--------------------------	-------------------------------------	--------------------------

b) Does the project include recreational facilities or require the construction or expansion of recreational facilities which might have an adverse physical effect on the environment?

<input type="checkbox"/>	<input type="checkbox"/>	<input type="checkbox"/>	<input checked="" type="checkbox"/>	<input type="checkbox"/>
--------------------------	--------------------------	--------------------------	-------------------------------------	--------------------------

**Impact Discussion:**

a-b) This project will not increase the use of existing neighborhood and regional parks or other recreational facilities such that substantial physical deterioration of the facility would occur or be accelerated, because the project will not generate any new residential units and the impacts to parks generated by the employees of this project will be minimal. This project does not include recreational facilities or require the construction or expansion of recreational facilities, which might have an adverse physical effect on the environment, because the type of project proposed, a retail store, will not result in an increased demand for recreational facilities. Therefore, the project will have no impact on recreation facilities.

Potentially Significant Impact	Less Than Significant with Mitigation Incorporated	Less Than Significant Impact	No Impact	Analyzed In The Prior EIR
--------------------------------------	---	------------------------------------	--------------	---------------------------------

**XVII. TRANSPORTATION.**

Would the project:

a) Conflict with a program plan, ordinance, or policy addressing the circulation system, including transit, roadways, bicycle, and pedestrian facilities?	<input type="checkbox"/>	<input type="checkbox"/>	<input checked="" type="checkbox"/>	<input type="checkbox"/>	<input type="checkbox"/>
b) Would the project conflict or be inconsistent with CEQA Guidelines section 15064.3, subdivision (b)?	<input type="checkbox"/>	<input type="checkbox"/>	<input checked="" type="checkbox"/>	<input type="checkbox"/>	<input type="checkbox"/>
c) Substantially increase hazards due to a geometric design feature (e.g., sharp curves or dangerous intersections) or incompatible uses (e.g., farm equipment)?	<input type="checkbox"/>	<input type="checkbox"/>	<input checked="" type="checkbox"/>	<input type="checkbox"/>	<input type="checkbox"/>
d) Result in inadequate emergency access?	<input type="checkbox"/>	<input type="checkbox"/>	<input checked="" type="checkbox"/>	<input type="checkbox"/>	<input type="checkbox"/>

**Impact Discussion:**

a-d) The proposed project is a Site Approval application for an auction sales facility has been screened from completing a Vehicle Miles Traveled (VMT) Analysis and is expected to produce less than 110 daily trips. Therefore, the project is presumed to have a less than significant impact on traffic.

Potentially Significant Impact	Less Than Significant with Mitigation Incorporated	Less Than Significant Impact	No Impact	Analyzed In The Prior EIR
--------------------------------------	---	------------------------------------	--------------	---------------------------------

**XVIII. TRIBAL CULTURAL RESOURCES.**

a) Would the project cause a substantial adverse change in the significance of a tribal cultural resource, defined in Public Resources Code section 21074 as either a site, feature, place, cultural landscape that is geographically defined in terms of the size and scope of the landscape, sacred place, or object with cultural value to a California Native American tribe, and that is:

i) Listed or eligible for listing in the California Register of Historical Resources, or in a local register of historical resources as defined in Public Resources Code section 5020.1(k), or

<input type="checkbox"/>	<input type="checkbox"/>	<input type="checkbox"/>	<input checked="" type="checkbox"/>	<input type="checkbox"/>
--------------------------	--------------------------	--------------------------	-------------------------------------	--------------------------

ii) A resource determined by the lead agency, in its discretion and supported by substantial evidence, to be significant pursuant to criteria set forth in subdivision (c) of Public Resources Code Section 5024.1. In applying the criteria set forth in subdivision (c) of Public Resource Code Section 5024.1, the lead agency shall consider the significance of the resource to a California Native American tribe.

<input type="checkbox"/>	<input type="checkbox"/>	<input type="checkbox"/>	<input checked="" type="checkbox"/>	<input type="checkbox"/>
--------------------------	--------------------------	--------------------------	-------------------------------------	--------------------------

**Impact Discussion:**

a) This project is located in the unincorporated community of Stockton, 0.27 miles southwest of State Route Highway 99.

The project must comply with state and federal laws regarding any resources or remains found during construction. If, in the course of development, concentrations of prehistoric or historic-period materials are encountered, all work in the vicinity of the find must be halted until an archaeologist can evaluate the materials and make recommendations for further action. If human remains are encountered, all work must halt in the vicinity and the County Coroner shall be notified immediately. At the same time, a qualified archaeologist shall be contacted to evaluate the finds. If Human burials are found to be of Native American origin, steps shall be taken pursuant to Section 15064.5(e) of Guidelines for California Environmental Quality Act. The North Valley Yokuts Tribe and the United Auburn Indian Community were sent a referral for the project on November 22, 2019 and a response was not received.



Potentially Significant Impact	Less Than Significant with Mitigation Incorporated	Less Than Significant Impact	No Impact	Analyzed In The Prior EIR
--------------------------------------	---	------------------------------------	--------------	---------------------------------

**XIX. UTILITIES AND SERVICE SYSTEMS.**

Would the project:

a) Require or result in the relocation or construction of new or expanded water, wastewater treatment, or storm water drainage, electric power, natural gas, or telecommunications facilities, the construction or relocation of which could cause significant environmental effects?	<input type="checkbox"/>	<input type="checkbox"/>	<input checked="" type="checkbox"/>	<input type="checkbox"/>	<input type="checkbox"/>
b) Have sufficient water supplies available to serve the project and reasonably foreseeable future development during normal, dry and multiple dry years?	<input type="checkbox"/>	<input type="checkbox"/>	<input checked="" type="checkbox"/>	<input type="checkbox"/>	<input type="checkbox"/>
c) Result in a determination by the wastewater treatment provider which serves or may serve the project that it has adequate capacity to serve the project's projected demand in addition to the provider's existing commitments?	<input type="checkbox"/>	<input type="checkbox"/>	<input checked="" type="checkbox"/>	<input type="checkbox"/>	<input type="checkbox"/>
d) Generate solid waste in excess of State or local standards, or in excess of the capacity of local infrastructure, or otherwise impair the attainment of solid waste reduction goals?	<input type="checkbox"/>	<input type="checkbox"/>	<input checked="" type="checkbox"/>	<input type="checkbox"/>	<input type="checkbox"/>
e) Comply with federal, state, and local management and reduction statutes and regulations related to solid waste?	<input type="checkbox"/>	<input type="checkbox"/>	<input checked="" type="checkbox"/>	<input type="checkbox"/>	<input type="checkbox"/>

**Impact Discussion:**

a-e) The project is a Site Approval for an auction sales facility. The parcels will be served by public utility systems. The City of Stockton will provide sewer service, the California Water Service will provide water, and the City of Stockton will provide storm drainage. The utility agencies have provided will-serve letters verifying service to the proposed project site. Therefore, the project will have a less than significant impact on existing utilities and service systems.

	Potentially Significant Impact	Less Than Significant with Mitigation Incorporated	Less Than Significant Impact	No Impact	Analyzed In The Prior EIR
--	--------------------------------	--	------------------------------	-----------	---------------------------

**XX. WILDFIRE.**

If located in or near state responsibility areas or lands classified as very high fire hazard severity zones, would the project:

a) Substantially impair an adopted emergency response plan or emergency evacuation plan?	<input type="checkbox"/>	<input type="checkbox"/>	<input checked="" type="checkbox"/>	<input type="checkbox"/>	<input type="checkbox"/>
b) Due to slope, prevailing winds, and other factors, exacerbate wildfire risks, and thereby expose project occupants to pollutant concentrations from a wildfire or the uncontrolled spread of a wildfire?	<input type="checkbox"/>	<input type="checkbox"/>	<input checked="" type="checkbox"/>	<input type="checkbox"/>	<input type="checkbox"/>
c) Require the installation or maintenance of associated infrastructure (such as roads, fuel breaks, emergency water sources, power lines or other utilities) that may exacerbate fire risk or that may result in temporary or ongoing impacts to the environment?	<input type="checkbox"/>	<input type="checkbox"/>	<input checked="" type="checkbox"/>	<input type="checkbox"/>	<input type="checkbox"/>
d) Expose people or structures to significant risks, including downslope or downstream flooding or landslides, as a result of runoff, post-fire slope instability, or drainage changes?	<input type="checkbox"/>	<input type="checkbox"/>	<input checked="" type="checkbox"/>	<input type="checkbox"/>	<input type="checkbox"/>

**Impact Discussion:**

a-d) The proposed project is a Site Approval for an auction sales facility. The project location is in the unincorporated urban community of Stockton, CA, and the project parcel is not identified as a Community at Risk from Wildfire by Cal Fire's "Fire Risk Assessment Program". Communities at Risk from Wildfire are those places within 1.5 miles of areas of High or Very High wildfire threat as determined from CDF-FRAP fuels and hazard data. However, the South San Joaquin County Fire Authority has required an on-site fire suppression water supply for this project due to the nature of the use. Therefore, the impact of wildfires on the project are expected to be less than significant.



Potentially Significant Impact	Less Than Significant with Mitigation Incorporated	Less Than Significant Impact	No Impact	Analyzed In The Prior EIR
--------------------------------	--	------------------------------	-----------	---------------------------

**XXI. MANDATORY FINDINGS OF SIGNIFICANCE.**

a) Does the project have the potential to substantially degrade the quality of the environment, substantially reduce the habitat of a fish or wildlife species, cause a fish or wildlife population to drop below self-sustaining levels, threaten to eliminate a plant or animal community, substantially reduce the number or restrict the range of a rare or endangered plant or animal or eliminate important examples of the major periods of California history or prehistory?

<input type="checkbox"/>	<input checked="" type="checkbox"/>	<input type="checkbox"/>	<input type="checkbox"/>	<input type="checkbox"/>
--------------------------	-------------------------------------	--------------------------	--------------------------	--------------------------

b) Does the project have impacts that are individually limited, but cumulatively considerable? ("Cumulatively considerable" means that the incremental effects of a project are considerable when viewed in connection with the effects of past projects, the effects of other current projects, and the effects of probable future projects)?

<input type="checkbox"/>	<input type="checkbox"/>	<input checked="" type="checkbox"/>	<input type="checkbox"/>	<input type="checkbox"/>
--------------------------	--------------------------	-------------------------------------	--------------------------	--------------------------

c) Does the project have environmental effects which will cause substantial adverse effects on human beings, either directly or indirectly?

<input type="checkbox"/>	<input type="checkbox"/>	<input checked="" type="checkbox"/>	<input type="checkbox"/>	<input type="checkbox"/>
--------------------------	--------------------------	-------------------------------------	--------------------------	--------------------------

**Impact Discussion:**

a) The proposed project does not appear to have the potential to significantly degrade the overall quality of the region's environment, or substantially reduce the habitat of a fish or wildlife species, cause a fish or wildlife population to drop below self-sustaining levels, threaten to eliminate a plant or animal community, reduce the number or restrict the range of a rare or endangered plant or animal or eliminate important examples of the major periods of California history or prehistory. There are no identified historic or prehistoric resources identified on this site. No archaeological or paleontological resources have been identified in the project area.

The applicant has confirmed that he will participate in the *San Joaquin County Multi-Species Habitat Conservation and Open Space Plan (SJMSCP)*, which provides compensation for the conversion of Open Space to non-Open Space uses which affect the plant, fish and wildlife species covered by the Plan. With the applicant's participation, the proposed project is consistent with the SJMSCP and any impacts to biological resources resulting from the proposed project will be reduced to a level of less-than-significant

b) The project is not expected to have cumulatively considerable impacts. Less than significant impacts to air quality, biological resources, traffic improvements, and hydrology have been identified. Any potential impacts will be adequately addressed through conditions of approval and compliance with existing laws and regulations.

c) The project does not have environmental effects which will cause substantial adverse effects on human beings.

Note: Authority cited: Sections 21083, 21083.05, Public Resources Code. Reference: Section 65088.4, Gov. Code; Sections 21080, 21083.05, 21095, Pub. Resources Code; Eureka Citizens for Responsible Govt. v. City of Eureka (2007) 147 Cal.App.4th 357; Protect the Historic Amador Waterways v. Amador Water Agency (2004) 116 Cal.App.4th at 1109; San Franciscans Upholding the Downtown Plan v. City and County of San Francisco (2002) 102 Cal.App.4th 656.

ATTACHMENT: (MAP[S] OR PROJECT SITE PLAN[S])

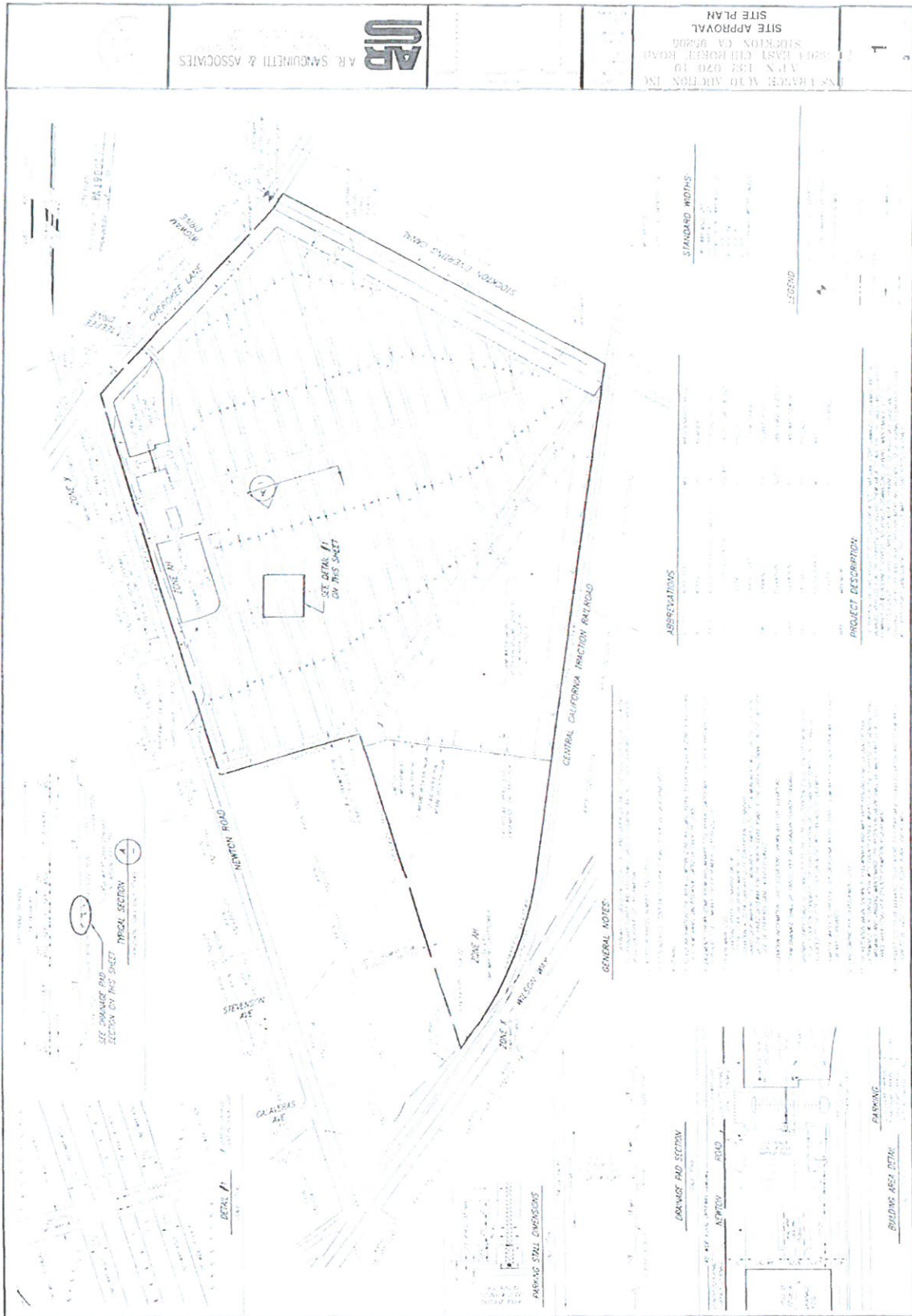

  
 A.R. SARGUINETTI & ASSOCIATES

SITE APPROVAL  
 1000 EAST CHERRY ROAD  
 ALHAMBRA, CA 91801  
 WINSLOW WILSON ARCHITECTS INC.

**STANDARD WIDTHS**

STREET	10'
ALLEY	10'
BIWAY	10'
TRAIL	10'
WALKWAY	10'
BIWAY	10'
TRAIL	10'
WALKWAY	10'

**ABSTRACTS**

**PROJECT DESCRIPTION**

**GENERAL NOTES**

1. ALL DIMENSIONS ARE IN FEET AND INCHES.
2. ALL DIMENSIONS ARE TO FACE UNLESS OTHERWISE NOTED.
3. ALL DIMENSIONS ARE TO CENTERLINE UNLESS OTHERWISE NOTED.
4. ALL DIMENSIONS ARE TO CENTERLINE UNLESS OTHERWISE NOTED.
5. ALL DIMENSIONS ARE TO CENTERLINE UNLESS OTHERWISE NOTED.
6. ALL DIMENSIONS ARE TO CENTERLINE UNLESS OTHERWISE NOTED.
7. ALL DIMENSIONS ARE TO CENTERLINE UNLESS OTHERWISE NOTED.
8. ALL DIMENSIONS ARE TO CENTERLINE UNLESS OTHERWISE NOTED.
9. ALL DIMENSIONS ARE TO CENTERLINE UNLESS OTHERWISE NOTED.
10. ALL DIMENSIONS ARE TO CENTERLINE UNLESS OTHERWISE NOTED.

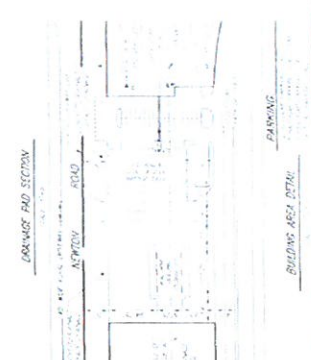



### Notice of Completion & Environmental Document Transmittal

Mail to: State Clearinghouse, P.O. Box 3044, Sacramento, CA 95812-3044 (916) 445-0613  
For Hand Delivery/Street Address: 1400 Tenth Street, Sacramento, CA 95814

SCH #

Project Title: PA-1900197 (SA)

Lead Agency: San Joaquin County

Contact Person: Teddie Hernandez

Mailing Address: 1810 E Hazelton Avenue

Phone: 209-468-8359

City: Stockton

Zip: 95205

County: San Joaquin

Project Location: County: San Joaquin

City/Nearest Community: Stockton

Cross Streets: N. Newton Road

Zip Code: 95205

Longitude/Latitude (degrees, minutes and seconds): \_\_\_\_\_ "N / \_\_\_\_\_ "W Total Acres: 1.398

Assessor's Parcel No.: 132-070-10

Section: 41,42,53

Twp.: T2N

Range: R7E

Base: 53

Within 2 Miles: State Hwy #: N/A

Waterways: N/A

Airports: N/A

Railways: Main CCT

Schools: Stockton Unified

#### Document Type:

CEQA:  NOP

Early Cons

Neg Dec

Mit Neg Dec

Draft EIR

Supplement/Subsequent EIR

(Prior SCH No.)

Other: \_\_\_\_\_

NEPA:  NOI

EA

Draft EIS

FONSI

Other:  Joint Document

Final Document

Other: \_\_\_\_\_

#### Local Action Type:

General Plan Update

General Plan Amendment

General Plan Element

Community Plan

Specific Plan

Master Plan

Planned Unit Development

Site Plan

Rezone

Prezone

Use Permit

Land Division (Subdivision, etc.)

Annexation

Redevelopment

Coastal Permit

Other: \_\_\_\_\_

#### Development Type:

Residential: Units \_\_\_\_\_ Acres \_\_\_\_\_

Office: Sq.ft. \_\_\_\_\_ Acres \_\_\_\_\_ Employees \_\_\_\_\_

Commercial: Sq.ft. 14,838 Acres \_\_\_\_\_ Employees 180

Industrial: Sq.ft. \_\_\_\_\_ Acres \_\_\_\_\_ Employees \_\_\_\_\_

Educational: \_\_\_\_\_

Recreational: \_\_\_\_\_

Water Facilities: Type \_\_\_\_\_ MGD \_\_\_\_\_

Transportation: Type \_\_\_\_\_

Mining: Mineral \_\_\_\_\_

Power: Type \_\_\_\_\_ MW \_\_\_\_\_

Waste Treatment: Type \_\_\_\_\_ MGD \_\_\_\_\_

Hazardous Waste: Type \_\_\_\_\_

Other: \_\_\_\_\_

#### Project Issues Discussed in Document:

Aesthetic/Visual

Agricultural Land

Air Quality

Archeological/Historical

Biological Resources

Coastal Zone

Drainage/Absorption

Economic/Jobs

Fiscal

Flood Plain/Flooding

Forest Land/Fire Hazard

Geologic/Seismic

Minerals

Noise

Population/Housing Balance

Public Services/Facilities

Recreation/Parks

Schools/Universities

Septic Systems

Sewer Capacity

Soil Erosion/Compaction/Grading

Solid Waste

Toxic/Hazardous

Traffic/Circulation

Vegetation

Water Quality

Water Supply/Groundwater

Wetland/Riparian

Growth Inducement

Land Use

Cumulative Effects

Other: \_\_\_\_\_

#### Present Land Use/Zoning/General Plan Designation:

Vacant Land / I-G (General Industrial) / I/G (General Industrial)

#### Project Description: (please use a separate page if necessary)

A Site Approval application for an auction sales facility to be developed on a 139.8-acre parcel in the General Industrial Zone (I-G). The project includes the construction of a 9,750 square foot office building and a 5,088 square foot warehouse building. The operation will take place 8:00 a.m. to 5:00 p.m. Monday through Friday with fifty (50) employees. Deliveries of vehicles will take place 5:00 p.m. to 8:00 a.m. seven (7) days per week. The parcel will be served by public sewer by the City of Stockton, public water by the California Water Service, and public storm drainage by San Joaquin County. Access to the parcel will be off of Cherokee Lane and Newton Road. This parcel is not under a Williamson Act contract. (Use Type: Auction Sales - Indoor & Outdoor).

Note: The State Clearinghouse will assign identification numbers for all new projects. If a SCH number already exists for a project (e.g. Notice of Preparation or previous draft document) please fill in.



## Reviewing Agencies Checklist

Lead Agencies may recommend State Clearinghouse distribution by marking agencies below with an "X".  
If you have already sent your document to the agency please denote that with an "S".

- |   |  |
|---|--|
| <input type="checkbox"/> Air Resources Board                          | <input type="checkbox"/> Office of Historic Preservation                     |
| <input type="checkbox"/> Boating & Waterways, Department of           | <input type="checkbox"/> Office of Public School Construction                |
| <input type="checkbox"/> California Emergency Management Agency       | <input type="checkbox"/> Parks & Recreation, Department of                   |
| <input checked="" type="checkbox"/> California Highway Patrol         | <input type="checkbox"/> Pesticide Regulation, Department of                 |
| <input checked="" type="checkbox"/> Caltrans District #10             | <input type="checkbox"/> Public Utilities Commission                         |
| <input type="checkbox"/> Caltrans Division of Aeronautics             | <input checked="" type="checkbox"/> Regional WQCB #CV                        |
| <input checked="" type="checkbox"/> Caltrans Planning                 | <input type="checkbox"/> Resources Agency                                    |
| <input type="checkbox"/> Central Valley Flood Protection Board        | <input type="checkbox"/> Resources Recycling and Recovery, Department of     |
| <input type="checkbox"/> Coachella Valley Mtns. Conservancy           | <input type="checkbox"/> S.F. Bay Conservation & Development Comm.           |
| <input type="checkbox"/> Coastal Commission                           | <input type="checkbox"/> San Gabriel & Lower L.A. Rivers & Mtns. Conservancy |
| <input type="checkbox"/> Colorado River Board                         | <input type="checkbox"/> San Joaquin River Conservancy                       |
| <input type="checkbox"/> Conservation, Department of                  | <input type="checkbox"/> Santa Monica Mtns. Conservancy                      |
| <input type="checkbox"/> Corrections, Department of                   | <input checked="" type="checkbox"/> State Lands Commission                   |
| <input type="checkbox"/> Delta Protection Commission                  | <input type="checkbox"/> SWRCB: Clean Water Grants                           |
| <input type="checkbox"/> Education, Department of                     | <input type="checkbox"/> SWRCB: Water Quality                                |
| <input type="checkbox"/> Energy Commission                            | <input type="checkbox"/> SWRCB: Water Rights                                 |
| <input checked="" type="checkbox"/> Fish & Game Region #2             | <input type="checkbox"/> Tahoe Regional Planning Agency                      |
| <input checked="" type="checkbox"/> Food & Agriculture, Department of | <input type="checkbox"/> Toxic Substances Control, Department of             |
| <input type="checkbox"/> Forestry and Fire Protection, Department of  | <input type="checkbox"/> Water Resources, Department of                      |
| <input type="checkbox"/> General Services, Department of              | Other: _____   |
| <input checked="" type="checkbox"/> Health Services, Department of    | Other: _____   |
| <input type="checkbox"/> Housing & Community Development              |  |
| <input type="checkbox"/> Native American Heritage Commission          |  |

-----

### Local Public Review Period (to be filled in by lead agency)

Starting Date 10-9-2020 Ending Date 11-9-2020

-----

### Lead Agency (Complete if applicable):

Consulting Firm: _____	Applicant: <u>Insurance Auto Auctions, Inc., C/O Steve Malcoun</u>
Address: _____	Address: <u>2453 Grand Canal Blvd.</u>
City/State/Zip: _____	City/State/Zip: <u>Stockton, Ca 95207</u>
Contact: _____	Phone: _____
Phone: _____	

-----

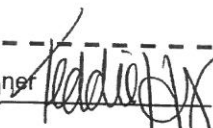
Signature of Lead Agency Representative: Teddie Hernandez, Associate Planner  Date: 9/11/2020

Authority cited: Section 21083, Public Resources Code. Reference: Section 21161, Public Resources Code.

